

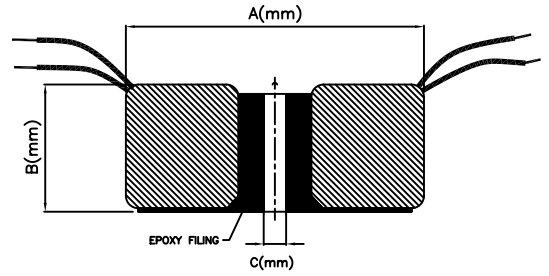

**TOROID-SERIES-Fly Leads**  
**100VA to 1200VA**  
**ISOLATION TRANSFORMER**



Dimensional drawing



**Specifications:**

Dual Primary: 115 / 230V @ 50 / 60Hz

Dual Secondary: 115 / 230V

Power: 100VA to 1200VA

Dielectric Strength: 3000Vrms

**Agency Standards**

Class B Insulation(130 Degree C )

Built to meet CAN / CSA E60065-94

Built to meet UL1411

Built to meet IEC60065

Standard samples will be despatched within 24 hours of receiving order.

Kindly indicate the part number while inquiring.

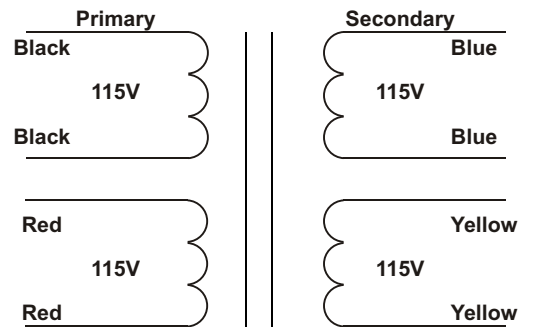

**Technical Data:**

Part Number	VA (Size)	Secondary		Mechanical Dimensions (mm)			Weight (KG)
		Series Connected	Parallel Connected	A	B	C	
S-TR917-0100	100	230V CT @ 0.435A 230V CT	115V @ 0.870A 115V	100	50	6	1.35
S-TR918-0160	160	230V CT @ 0.695A 230V CT	115V @ 1.39A 115V	100	60	6	1.72
S-TR919-0260	260	230V CT @ 1.13A 230V CT	115V @ 2.26A 115V	115	60	8	2.58
S-TR920-0320	320	230V CT @ 1.39A 230V CT	115V @ 2.78A 115V	125	60	8	2.88
S-TR921-0600	600	230V CT @ 2.61A 230V CT	115V @ 5.22A 115V	135	80	10	4.55
S-TR922-1200	1200	230V CT @ 5.21A 230V CT	115V @ 10.42A 115V	165	90	10	7.70

Custom made transformers are available on request.



**SHILCHAR**  
**TECHNOLOGIES LIMITED**

